

## 32. BIAB OVERLAY

BIAB overlays can be performed over natural nails or tip extensions. Lastik is a popular choice for BIAB manicures, but you can use PUG in the same way.

Prepare the nails following your nail prep steps, ensuring that there's no shine on the nail surface. Apply, cut and shape the tips if tips are being used. Dust and sanitize the nails with The One Spray and a Nail Wipe.

### Prepping Product Application

1. Apply PN Nail Prep to natural nail only, avoiding contact with cuticle area. Wait for it to dry chalky white (optional). Apply PN Primer/ PN Sticky Bond to natural nail only, avoiding contact with cuticle area. Wait for it to dry. (if no nail prep is used, apply 2 coats of Sticky Bond)
2. Apply a base coat (optional) of Lastik/Stick 'n Float Gel over the entire nail. Start 1 mm away from the cuticle area, off-loading before pushing the gel back towards the cuticle area, followed by sweeping the gel down the length of the nail. Apply to the sides of the nail in smooth sweeps. Do not touch the cuticle and side wall areas. Extend the gel just past the free edge to allow for shrinkage during curing. Seal all sides of the free edge. Complete all 4 fingers on the first hand and cure for 60 seconds under your PN Speciality Dual Cure Lamp. (instances where we would recommend a base layer is when the surface is uneven - like in cases of where a tip has been applied or if the nail plate has any irregularities; or if the chosen builder was a permanent/hard gel and a soak-off base coat is needed)
3. Repeat step 2 on the 4 fingers on the other hand (if a base coat is needed).
4. Repeat step 2 on both thumbs, ensure you're curing the thumbs flat (if a base coat is needed).

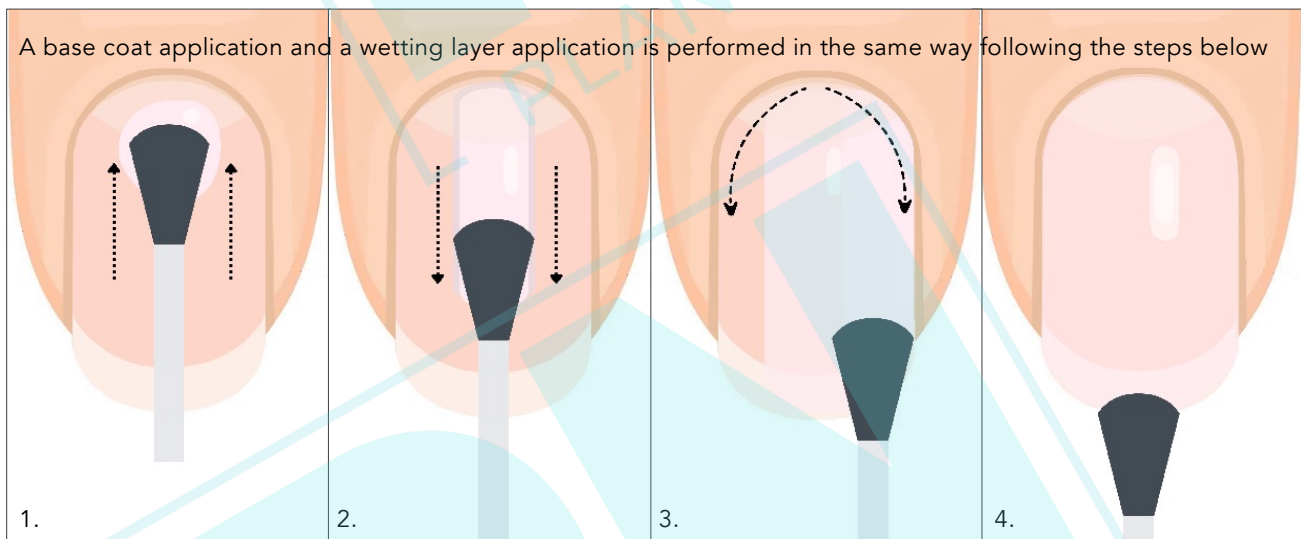

5. Apply a thin wetting layer of PUG/ Lastik/ Lastik Plus to the entire nail, like applying a nail polish- **don't cure** (follow the same steps as the base coat layer above). Your wetting layer works like a foundation or map letting your building layer know where to self-level to. Pick up a moderate bead of your chosen builder Gel and place the Gel in the back third (in the centre) of the nail. Maintain contact with the bead of gel but don't apply any pressure. Hold the nail level and tail a line of Gel down the centre of the nail bed. This line should self-level within seconds, with a liner brush you are able to draw the Gel to the sides without touching the middle, which would ensure your arch/apex. You can use gravity to help create an apex, turn the finger over, holding it parallel with the table, which will help the gel pull to the centre of the nail. Or you can hold the finger between a 35–45-degree angle to help the apex settle in the back third of the nail, depending on the length of nail you are working with. Use the reflection of light from your desk lamp to see if you're happy with the smoothness and once you are happy with your gel application, cure under PN Speciality Dual Cure Lamp for 60sec. When applying your building layer perform this step one finger at a time, alternating hands until all 10 fingers have been done- ensuring you are curing each finger flat including the thumbs.

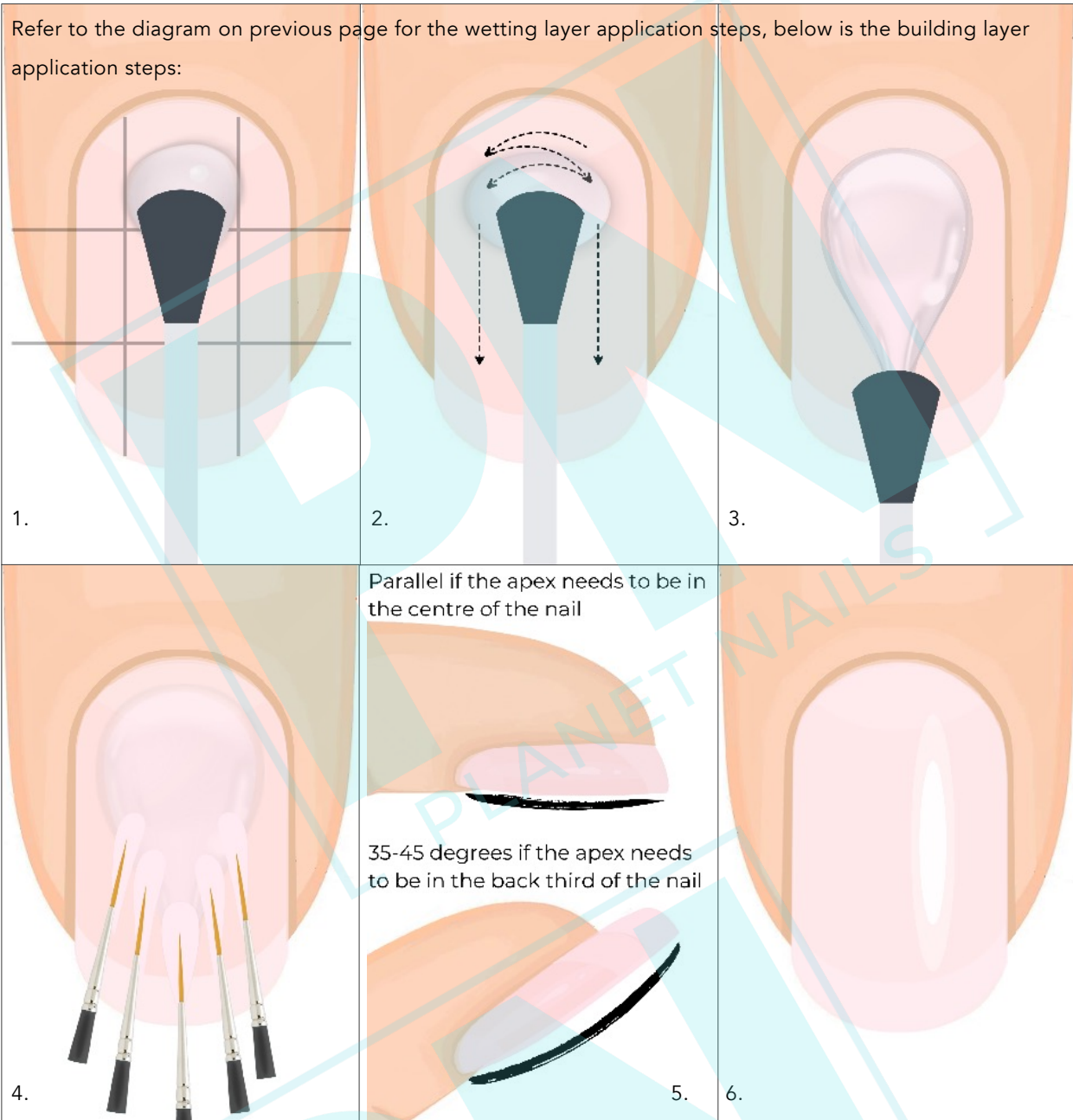

6. Repeat with another layer of Gel if needed. Seal all sides of the free edge. Cure for 60 seconds under your PN Speciality Dual Cure Lamp. (we would recommend to perform 2 layers in cases where achieving the correct structure in 1 layer is harder, like with flat, ski-jump or deformed nails; or long nails – in these cases you would aim to achieve 50% of the required structure per layer)
7. If refining/finishing is needed, wipe with The One Spray and a nail wipe to remove sticky residue. Use a 180grit File or your Safety Bit and e-file, to eliminate any bumps and unevenness. Refine the shape, pay attention to the side wall and free edge area. Remember Gel will not adhere to a shiny surface, therefore buff entire nail with a Block Buffer or a sanding roller over a mandrel bit, to remove shine everywhere. Remove dust with a manicure brush. Apply The One Spray to a Nail Wipe and wipe nails to clear dust particles. The nail is now ready for its final layer of Gel (topcoat) (or Gel Polish Colour/ French look ).
8. Apply Planet Gel Polish no-wipe Topcoat. Seal all sides of the free edge. Cure for 60 seconds under your PN Speciality Dual Cure Lamp. Wipe the nails with a nail wipe saturated with The One spray. Ask your client to wash her hands ensuring she's removing any excess product/dust form her skin. Apply Cuticle Oil.

Take an after picture and complete client record card, advise client on homecare and schedule her next appointment.